

APPROVED: \_\_\_\_\_  
 DATE: \_\_\_\_\_ TITLE: \_\_\_\_\_

Rev	AWO #	Description	Date	Appr
-		RELEASED	11/15/04	
A		REDRAWN	07/05/12	

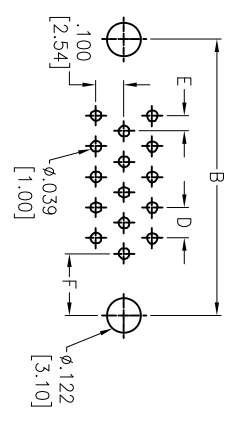

15 Position  
 RECOMMENDED PCB LAYOUT

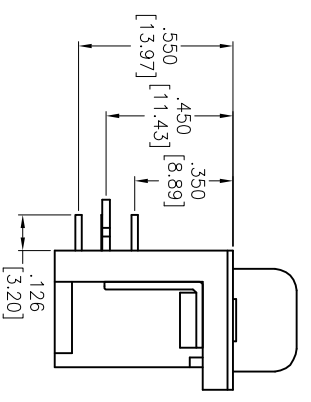
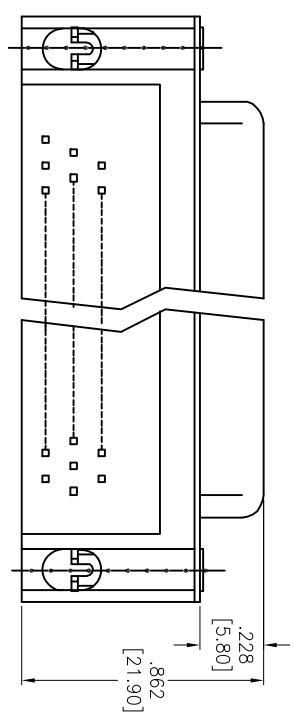
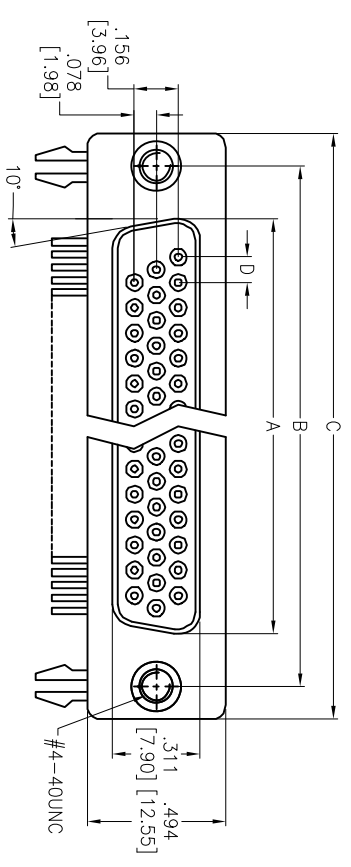
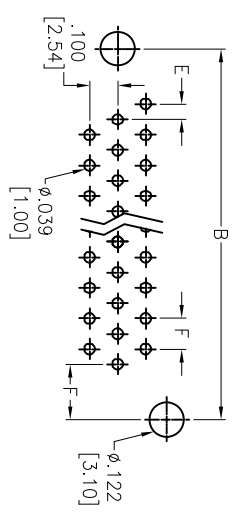

26, 44 & 62 Position  
 RECOMMENDED PCB LAYOUT

HDLXX	DIMENSIONS					
	A	B	C	D	E	F
15	.643 [16.33]	.984 [24.99]	1.213 [30.81]	.090 [2.29]	.045 [1.145]	.277 [7.04]
26	.971 [24.66]	1.312 [33.32]	1.541 [39.14]	.090 [2.29]	.045 [1.145]	.271 [6.88]
44	1.511 [38.38]	1.852 [47.04]	2.088 [53.04]	.090 [2.29]	.045 [1.145]	.271 [6.88]
62	2.159 [54.84]	2.500 [63.50]	2.729 [69.32]	.095 [2.41]	.047 [1.205]	.276 [7.00]

**ADAM TECH**

909 Railway Avenue, Union, NJ 07083  
 Phone: 908-687-5000 Fax: 908-687-5710

D-SUB, HIGH DENSITY, RIGHT ANGLE,  
 PCB

**SPECIFICATIONS:**  
 Material:  
 Insulator: PBT, glass reinforced, rated UL 94V-0  
 Insulator color: Black  
 Contacts: Phosphor Bronze  
 Shell: Steel, Zinc plated  
 Hardware: Brass, Nickel plated  
 Plating:  
 Gold Flash nom over Nickel underplate overall  
 Electrical:  
 Operating voltage: 250 VAC max  
 Current rating: 1 Amps max  
 Contact resistance: 20 mohms max  
 Insulation resistance: 5000 Mohms min @ 500 VDC  
 Dielectric withstanding voltage: 1000 VAC for 1 minute  
 Temperature Rating:  
 Operating temperature: -65°C to +125°C  
 Environmental:  
 Lead free, RoHS compliant. **RoHS**

UNLESS OTHERWISE SPECIFIED ALL DIMENSIONS ARE INCHES [MM]	
TOLERANCES: EXCEPT AS NOTED	
INCHES	HOLES
.X ± .10	ØX ± .10
.XX ± .020	ØXX ± .015
.XXX ± .015	ØXXX ± .010
APPROVALS	DATE
DRAWN	SS
CHECKED	
APPROVED	

TITLE	D-SUB, HIGH DENSITY, RIGHT ANGLE, PCB	
SIZE	PART NO.	HDLXX-SL-B
REF:	S00087T	SCALE: NTS
REV.		SHEET 1 OF 1